

A1.1 | **First Floor Plan**
1/4"=1'-0"

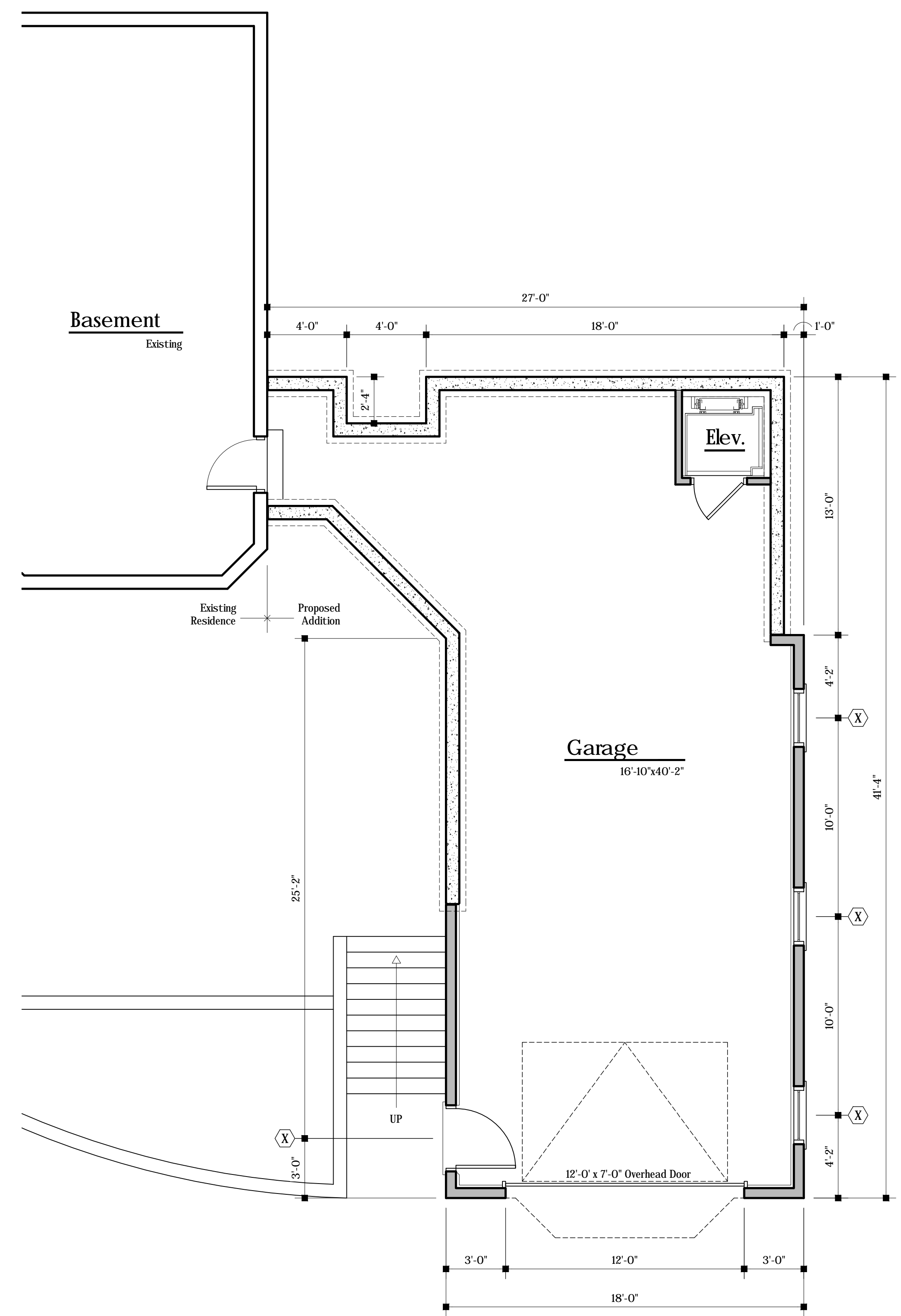

A1.2 | **Lower Floor Plan**
1/4"=1'-0"

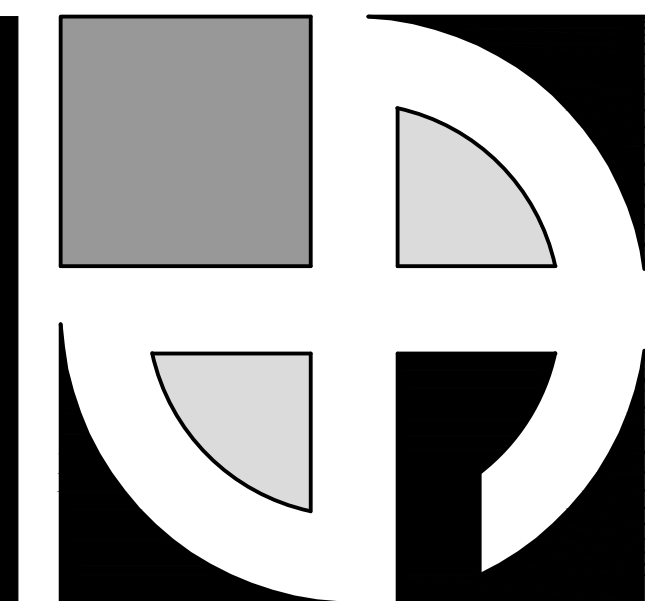

D E A N
ARCHITECTS

www.deanarchitects.com

PRELIMINARY
NOT FOR
CONSTRUCTION



3284 WALDEN AVENUE
DEPEW, NEW YORK 14043
PHONE: (716) 651-0381
FAX: (716) 651-0382

19-299

Project For:
Zydel Residence
8160 Hillside St.
Angola, NY

No.	Description	Date	By

DATE:
01-29-2020
DRAWN BY:
J. Strasser
CHECKED BY:
M. Dean
SCALE:
1/4"= 1'-0"

Preliminary Plans

A1

